

Valvula de asiento inclinado

Características

1. Válvula de Asiento Inclinado.
2. Construcción en acero inoxidable CF8M.
3. Actuador Simple efecto (Normal Cerrado).
4. Asiento de PTFE.
5. Extremos roscados según ASME B1.20.1 NPT.
6. Indicador de posición visual.
7. Presión máxima de trabajo: 16 bar.
8. Presión de aire de control: 3 ~ 8 bar.
9. Temperatura de trabajo: -10 °C ~ +180 °C
10. Viscosidad máxima de fluido: 600 mm² / s

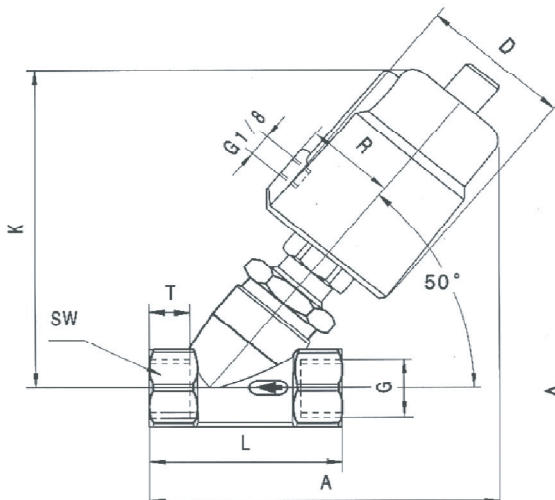

EXPERTOS EN ACERO INOXIDABLE

| Ref | DN | PN | Dimensiones / Dimensions (mm) | | | | | | | | Peso / Weight (g) |
|----------|----|----|-------------------------------|----|--------|-----|-----|----|----|----|-------------------|
| | | | A | D | G | K | L | SW | R | T | |
| 5060N 04 | 15 | 16 | 135 | 60 | 1/2" | 125 | 68 | 27 | 33 | 15 | 1300 |
| 5060N 05 | 20 | 16 | 140 | 60 | 3/4" | 132 | 75 | 32 | 33 | 16 | 1400 |
| 5060N 06 | 25 | 16 | 150 | 60 | 1" | 136 | 90 | 40 | 33 | 17 | 1700 |
| 5060N 07 | 32 | 16 | 190 | 75 | 1 1/4" | 174 | 116 | 50 | 41 | 21 | 3200 |
| 5060N 08 | 40 | 16 | 190 | 75 | 1 1/2" | 175 | 116 | 56 | 41 | 21 | 3600 |
| 5060N 09 | 50 | 16 | 205 | 75 | 2" | 183 | 138 | 69 | 41 | 22 | 4900 |

| Ref | DN | Paso / Hole | Kv | Diferencial de presión / Pressure differential ΔP (bar) | | Mínima presión de control según ΔP / Minimun control pressure According to ΔP | | Ø Actuador / Actuator (mm) | Volumen Actuador / Actuator volume (litro / liter) |
|----------|----|-------------|------|---|------|---|---------------|----------------------------|--|
| | | (mm) | | (m ³ / h) | Min. | Max. | ΔP min. (bar) | | |
| 5060N 04 | 15 | 13 | 4.7 | 0 | 16 | 3 | 3.5 | 50 | 0.05 |
| 5060N 05 | 20 | 18 | 9.5 | 0 | 16 | 3 | 4 | 50 | 0.05 |
| 5060N 06 | 25 | 24 | 18.1 | 0 | 16 | 3 | 4.5 | 50 | 0.05 |
| 5060N 07 | 32 | 31 | 23.1 | 0 | 16 | 3 | 5.5 | 63 | 0.11 |
| 5060N 08 | 40 | 35 | 32.9 | 0 | 16 | 3 | 6.5 | 63 | 0.11 |
| 5060N 09 | 50 | 45 | 52.8 | 0 | 9 | 3 | 7 | 63 | 0.11 |

PBX: (502) 2386 - 8787

inoxidable@mainco.com.gt

www.mainco.com.gt

42 calle 22-17 Colonia Industrial Santa Elisa zona 12, Bodega 5.

FORMA DE OPERACIÓN / OPERATION MODE

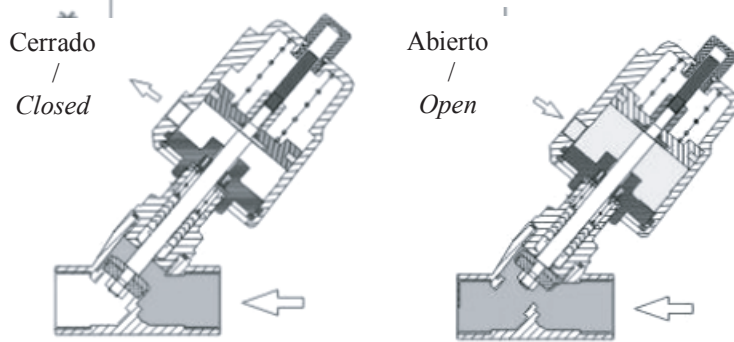

Actuador Simple Efecto (Retorno a resorte) Normal Cerrado (N.C.)

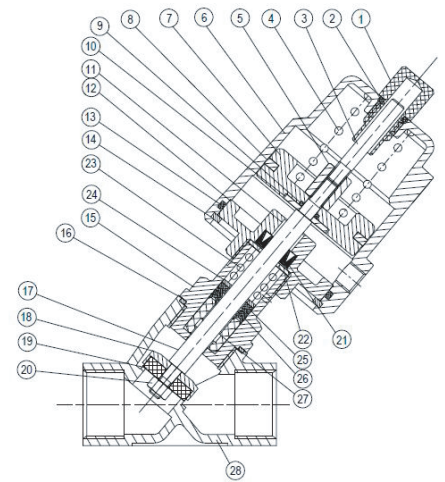

PARTES DE LA VÁLVULA / VALVE PARTS

| Nº | Denominación / Name | Material | Acabado Superficial / Surface Treatment | Cód. Recambio Spare Part Code |
|-----|---|--|---|-------------------------------|
| 1* | Protector Indicador / Indicator Protector | Plástico / Plastic | ----- | C5060 |
| 2 | Tórica / O'ring | NBR | ----- | ----- |
| 3 | Indicador / Indicator | Nylon | ----- | ----- |
| 4 | Muelle / Spring | Acero / Steel 65Mn | ----- | ----- |
| 5 | Tuerca / Nut | Aluminio / Aluminum | ----- | ----- |
| 6 | Cuerpo Actuador / Actuator Body | Acero Inox. / Stainless Steel CF8 (304) | Granallado / Shot blasting | ----- |
| 7 | Pistón / Piston | Aleación Aluminio / Aluminum Alloy | ----- | ----- |
| 8* | Sello de pistón / Piston Ring | FKM | ----- | R5060 |
| 9 | Tórica / O'ring | NBR | ----- | ----- |
| 10 | Arandela / Washer | Acero Inox. / Stainless Steel AISI 304 | ----- | ----- |
| 11 | Buje / Bearing | Aleación Aluminio / Aluminum Alloy | ----- | ----- |
| 12 | Tapa / Cover | Acero Inox. / Stainless Steel AISI 304 | ----- | ----- |
| 13* | Tórica / O'ring | NBR | ----- | R5060 |
| 14 | Anillo Seeguer / Check Ring | Acero Inox. / Stainless Steel AISI 304 | ----- | ----- |
| 15 | Conexión / Connection | Acero Inox. / Stainless Steel CF8M (316) | ----- | ----- |
| 16* | Junta de Cuerpo / Body Seal | PTFE | ----- | R5060 |
| 17 | Eje / Stem | Acero Inox. / Stainless Steel AISI 316 | ----- | ----- |
| 18 | Porta asiento / Seat Support | Acero Inox. / Stainless Steel CF8M (316) | ----- | ----- |
| 19* | Asiento / Seat | PTFE | ----- | R5060 |
| 20 | Tuerca / Nut | Acero Inox. / Stainless Steel AISI 316 | ----- | ----- |
| 21 | Reten / Y - Ring | FKM | ----- | ----- |
| 22 | Arandela / Washer | Acero Inox. / Stainless Steel AISI 304 | ----- | ----- |
| 23 | Muelle / Spring | Acero Inox. / Stainless Steel AISI 304 | ----- | ----- |
| 24 | Arandela / Washer | Acero Inox. / Stainless Steel AISI 304 | ----- | ----- |
| 25* | Empaquetadura / Stem Packing | PTFE + Carbon | ----- | E5060 |
| 26* | Empaquetadura / Stem Packing | PTFE | ----- | E5060 |
| 27* | Empaquetadura / Stem Packing | PTFE + Carbon | ----- | E5060 |
| 28 | Cuerpo Válvula / Valve Body | Acero Inox. / Stainless Steel CF8M (316) | Granallado / Shot blasting | ----- |